

LARGE BORE CHUCKS THREE JAW

Oil Country Chucks
 Heavy Duty or Medium Duty
 Extra Large Thru Hole
 Scroll and Master Jaws Ground and Hardened

Forged Steel Body or Semi Steel Body
 Two Piece Top Reversible Jaws
 Mounting Bolts
 Chuck Wrench

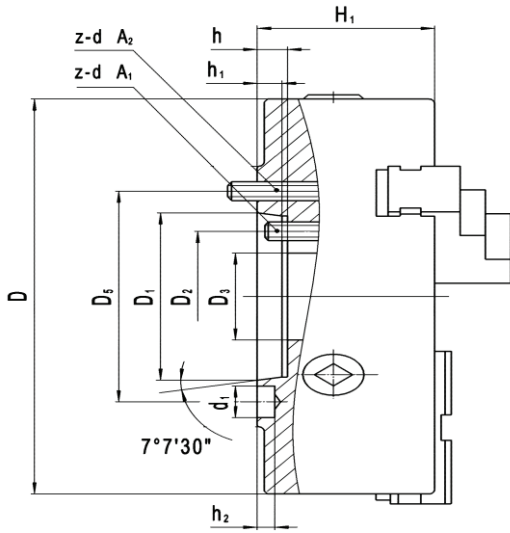

PRINCIPAL SPECIFICATIONS

Size	MODEL/MTG.	Hole Dia. D3	D	D1	D2/D5	H1	h	h1	h2	d1	z-d
25"	253A120R	12.520	24.803	16.251	14.500	6.850	0.875	0.748	0.394	1.657	6-1"-8 x 6"
25"	253A211R	7.520	24.803	7.751	9.252	6.063	0.787	0.630	0.394	1.160	6-M20 x 177
25"	253A215R	10.500	24.803	11.251	13.000	6.850	0.827	0.669	0.394	1.406	6-7/8"-9 x 7 1/2"
32"	323A211R	7.520	31.496	7.751	9.252	5.866	0.787	0.630	0.394	1.160	6-M20 x 150
32"	323A215R	11.000	31.496	11.251	13.000	5.866	0.669	/	0.394	1.406	6-M22 x 150
32"	323A220R	14.600	31.496	16.251	18.252	7.165	0.906	0.748	0.394	1.657	6-M24 x 200
40"	403A211R	7.520	39.370	7.751	9.252	8.583	0.784	0.630	0.394	1.160	6-M20
40"	403A215R	11.000	39.370	11.251	13.000	8.583	0.827	0.669	0.394	1.406	6-M22
40"	403A220R	14.600	39.370	16.251	18.252	8.583	0.906	0.748	0.394	1.657	6-M24
40"	403A228R	20.600	39.370	23.001	25.496	8.858	1.024	0.866	0.394	2.031	6-M30

Heavy Duty Three Jaw Forged Steel (1-)

Size	MODEL/MTG.	Torque (Nm)	Max RPM	Weight
25"	1-253A120R	400	1000	618
25"	1-253A211R	400	1000	740
25"	1-253A215R	400	1000	669
32"	1-323A211R	400	800	1060
32"	1-323A215R	400	800	984
32"	1-323A220R	400	800	1022
40"	1-403A211R	400	600	2411
40"	1-403A215R	400	600	2305
40"	1-403A220R	400	600	2124
40"	1-403A228R	400	600	1883

Medium Duty Three Jaw Semi Steel (2-)

Size	MODEL/MTG.	Torque (Nm)	Max RPM	Weight
25"	2-253A120R	400	800	530
25"	2-253A211R	400	800	629
25"	2-253A215R	400	800	568
32"	2-323A211R	400	500	900
32"	2-323A215R	400	500	836
32"	2-323A220R	400	500	860
40"	2-403A211R	400	400	2050
40"	2-403A215R	400	400	1950
40"	2-403A220R	400	400	1805
40"	2-403A228R	400	400	1601