

TWO JAW SELF CENTERING SCROLL CHUCKS FLATBACK - TOP REVERSIBLE JAWS

American standard two-piece tongue and groove jaws.
Scroll and jaws hardened and ground. Top reversible jaws.
Semi-steel body.

SUPPLIED WITH:

Master jaws and top jaws
T-Wrench
Mounting screws

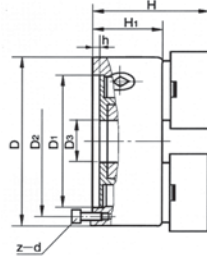

PRINCIPAL SPECIFICATIONS

Size	MODEL	WEIGHT	D	D1	D2	D3	H	H1	h	Z-d
6"	2062R	22	6.299	5.118	5.591	1.575	4.291	2.559	0.197	3-M8
8"	2082R	35	7.874	6.496	7.087	2.559	4.803	2.953	0.197	3-M10
10"	2102R	51	9.843	8.110	8.898	3.150	5.276	3.150	0.197	3-M12
12"	2122R	99	12.795	10.709	11.654	3.937	6.102	3.780	0.472	3-M16
15"	2152R	155	14.961	12.795	13.780	5.315	6.181	3.858	0.236	3-M16
20"	2202R	262	19.685	17.323	18.307	8.268	8.268	4.528	0.236	6-M16
25"	2252R	460	24.803	22.047	23.425	10.630	8.582	5.256	0.276	6-M16

SIX JAW SELF CENTERING SCROLL CHUCKS FLATBACK - SOLID JAWS

These chucks are suitable for clamping and machining thin walled workpieces.

SUPPLIED WITH:

One set of internal solid jaws
T-Wrench
Mounting screws

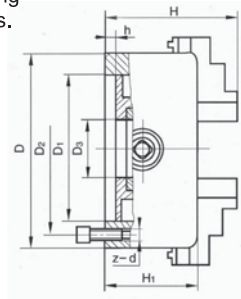

PRINCIPAL SPECIFICATIONS

Size	MODEL	WEIGHT	D	D1	D2	D3	H	H1	h	Z-d
4"	8046	8	3.937	2.835	3.307	1.024	2.874	2.106	0.138	3-M8
5"	8056	14	5.118	3.937	4.528	1.378	3.386	2.362	0.138	3-M8
6"	8066	21	6.496	5.118	5.709	1.654	3.799	2.618	0.177	3-M8
8"	8086	36	7.874	6.496	7.087	2.559	4.291	2.953	0.197	3-M10

0.003" TIR repeatability and meet ASA specifications on duplicate parts for chucks through 12"

5C PRECISION CHUCKS THREE JAW AND FOUR JAW

5C Precision chucks eliminate the problem of having to tear down a collet set-up.
You can easily switch to a 3 or 4 jaw chuck when collets aren't applicable.
Works with any 5C tooling.

SUPPLIED WITH:

2 set of hard jaws (3-Jaw chucks)
1 piece reversible jaws (4-Jaw chucks)
T Wrench

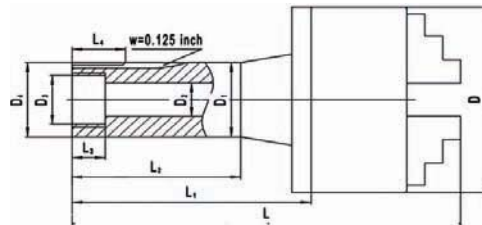

PRINCIPAL SPECIFICATIONS THREE JAW CHUCKS

SIZE	MODEL	WEIGHT	D	D1	D2	D3	D4	L	L1	L2	L3	L4
3"	5C033	7	3.150	1.250	0.7650	1.042-24	1.238-20	6.618	4.020	2.725	0.480	0.650
4"	5C043	11	3.937	1.250	0.7650	1.042-24	1.238-20	6.953	4.020	2.725	0.480	0.650

FOUR JAW CHUCKS

SIZE	MODEL	WEIGHT	D	D1	D2	D3	D4	L	L1	L2	L3	L4
3"	5C034	6	3.150	1.250	0.7650	1.042-24	1.238-20	6.220	4.020	2.725	0.480	0.650
4"	5C044	12	3.937	1.250	0.7650	1.042-24	1.238-20	6.929	4.020	2.725	0.480	0.650