

LARGE BORE CHUCKS THREE JAW

Oil Country Chucks
 Extra Heavy Duty or Heavy Duty
 Extra Large Thru Hole
 Scroll and Master Jaws Ground and Hardened

Solid Steel Body or Semi Steel Body
 Two Piece Top Reversible Jaws
 Mounting Bolts
 Chuck Wrench

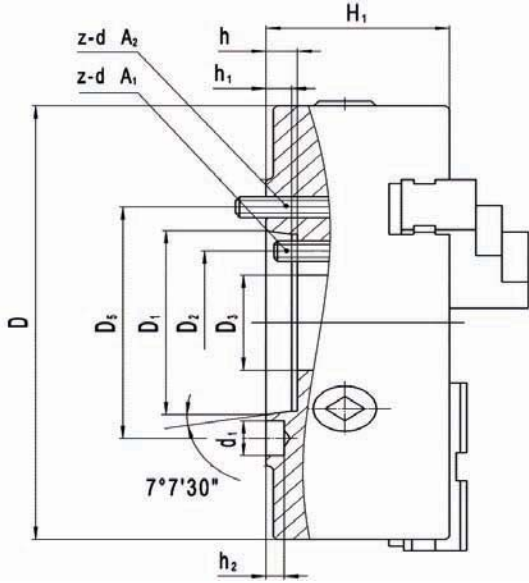

PRINCIPAL SPECIFICATIONS

| Size | MODEL/MTG. | Hole Dia. D3 | D | D1 | D2/D5 | H1 | h | h1 | h2 | d1 | z-d |
|------|--------------------------|--------------|--------|--------|--------|-------|-------|-------|-------|-------|-------------------|
| 25" | 253A120R | 12.520 | 24.803 | 16.251 | 14.500 | 6.850 | 0.875 | 0.748 | 0.394 | 1.657 | 6-1"-8 x 6" |
| 25" | 253A211R | 7.520 | 24.803 | 7.751 | 9.252 | 6.063 | 0.787 | 0.630 | 0.394 | 1.160 | 6-M20 x 177 |
| 25" | 253A215R | 10.512 | 24.803 | 11.251 | 13.000 | 6.850 | 0.827 | 0.669 | 0.394 | 1.406 | 6-7/8"-9 x 7 1/2" |
| 32" | 323A211R | 7.520 | 31.496 | 7.751 | 9.252 | 5.866 | 0.787 | 0.630 | 0.394 | 1.160 | 6-M20 x 150 |
| 32" | 323A215R | 11.083 | 31.496 | 11.251 | 13.000 | 5.866 | 0.669 | / | 0.394 | 1.406 | 6-M22 x 150 |
| 32" | 323A220R | 15.941 | 31.496 | 16.251 | 18.252 | 7.165 | 0.906 | 0.748 | 0.394 | 1.657 | 6-M24 x 200 |
| 40" | 403A211R | 7.520 | 39.370 | 7.751 | 9.252 | 8.583 | 0.784 | 0.630 | 0.394 | 1.160 | 6-M20 |
| 40" | 403A215R | 11.083 | 39.370 | 11.251 | 13.000 | 8.583 | 0.827 | 0.669 | 0.394 | 1.406 | 6-M22 |
| 40" | 403A220R | 15.157 | 39.370 | 16.251 | 18.252 | 8.583 | 0.906 | 0.748 | 0.394 | 1.657 | 6-M24 |
| 40" | 403A228R | 20.472 | 39.370 | 23.001 | 25.496 | 8.858 | 1.024 | 0.866 | 0.394 | 2.031 | 6-M30 |

Three Jaw Forged Steel (1-)

| Size | MODEL/MTG. | Torque (Nm) | Max RPM | Weight |
|------|----------------------------|-------------|---------|--------|
| 25"A | 1-253A120R | 400 | 1000 | 618 |
| 25"A | 1-253A211R | 400 | 1000 | 740 |
| 25"A | 1-253A215R | 400 | 1000 | 669 |
| 32"A | 1-323A211R | 400 | 800 | 1060 |
| 32"A | 1-323A215R | 400 | 800 | 984 |
| 32"A | 1-323A220R | 400 | 800 | 1022 |
| 40"B | 1-403A211R | 400 | 600 | 2411 |
| 40"B | 1-403A215R | 400 | 600 | 2305 |
| 40"B | 1-403A220R | 400 | 600 | 2124 |
| 40"B | 1-403A228R | 400 | 600 | 1883 |

Three Jaw Semi Steel (2-)

| Size | MODEL/MTG. | Torque (Nm) | Max RPM | Weight |
|------|----------------------------|-------------|---------|--------|
| 25"A | 2-253A120R | 400 | 800 | 530 |
| 25"A | 2-253A211R | 400 | 800 | 629 |
| 25"A | 2-253A215R | 400 | 800 | 568 |
| 32"A | 2-323A211R | 400 | 500 | 900 |
| 32"A | 2-323A215R | 400 | 500 | 836 |
| 32"A | 2-323A220R | 400 | 500 | 860 |
| 40"B | 2-403A211R | 400 | 400 | 2050 |
| 40"B | 2-403A215R | 400 | 400 | 1950 |
| 40"B | 2-403A220R | 400 | 400 | 1805 |
| 40"B | 2-403A228R | 400 | 400 | 1601 |

A Normally Stocked

B Call for delivery