

ZERO SET®

THREE JAW SCROLL CHUCKS WITH TOP REVERSIBLE JAWS

BTC® ZERO SET®

.0005" repeatability on duplicate parts. This accuracy is possible by having a clearance of .020" between the chuck cavity and the mounting plate hub. Opposing adjusting screws allow alignment to adjust work to "dead true" accuracy and repeatability on duplicate parts. With proper care BTC® Chucks useful life is approximately 2.5 times longer than standard self centering scroll chucks.

SUPPLIED WITH:

Chuck - Hardend Scroll,
Master Jaws and Top Jaws
T-Wrench
Mounting Screws

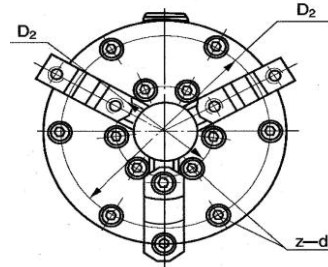

Backplates (page 6)

WORKHOLDING CAPACITIES AND MAXIMUM RPM LIMITS

SIZE	MODEL	OD MIN	OD MAX	ID MIN	ID MAX	MAX RPM
4"	1043	0.031	3.640	1.031	3.500	4000
5"	1053R	0.118	5.000	1.575	4.724	3500
6"	1063R	0.125	6.000	1.875	5.750	3400
8"	1083R	0.200	8.250	2.125	6.750	3100
10"	1103R	0.500	9.360	2.937	8.718	2700
12"	1123R	0.500	11.312	3.281	10.125	2200
15"	1153R	0.562	15.000	4.000	15.748	1800
21"	1213R	1.5000	21.000	4.750	20.250	1000

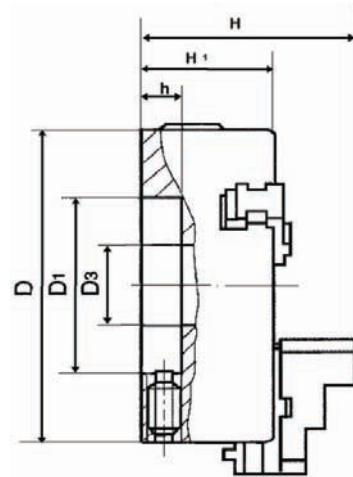

PRINCIPAL SPECIFICATIONS

SIZE	MODEL	WEIGHT	D	D1	D2	D3	H	H1	h	z-d
4" ₂	1043	10	4.000	2.125	3.530	1.024	3.071	2.323	0.657	3/16-24
5" ₂	1053R	15	5.000	2.716	4.438	1.299	3.768	2.205	0.657	1/4-20
6" ₂	1063R	19	6.000	3.125	5.343	1.535	3.882	2.323	0.689	1/4-20
8" ₂	1083R	50	8.270	4.750	7.500	2.264	5.206	3.122	0.752	3/8-16
10" ₁	1103R	70	10.000	6.374	4.375	2.835	6.056	3.492	0.803	7/16-14
12" ₁	1123R	116	12.000	7.905	5.250	3.268	6.569	3.980	0.803	1/2-13
15" ₁	1153R	200	15.000	11.781	6.750	4.252	8.799	5.362	1.063	5/8-11
21" ₁	1213R	395	21.000	10.030	9.250	5.275	9.520	6.250	1.188	3/4-10

₁ Inner Mtg. Holes D2 ₂ Outer Mtg. Holes D2

ZERO SET® THREE JAW CHUCKS WITH 5C and MORSE TAPER MOUNTS

SIZE	MODEL 3 Jaw	MODEL 6 Jaw	O.A. Length	MTG
4"	10435C	10465C	7.091	5C
5"	1053R5C	1056R5C	7.788	5C
6"	1063R5C	1066R5C	7.902	5C
5"	1053R3MT	1056R3MT	7.788	3MT
5"	1053R4MT	1056R4MT	7.788	4MT
6"	1063R5MT	1066R5MT	7.902	5MT



.0005" repeatability on duplicate parts.

SEE PAGE 7 FOR REPLACEMENT PARTS AND OPTIONAL SOFT JAWS